

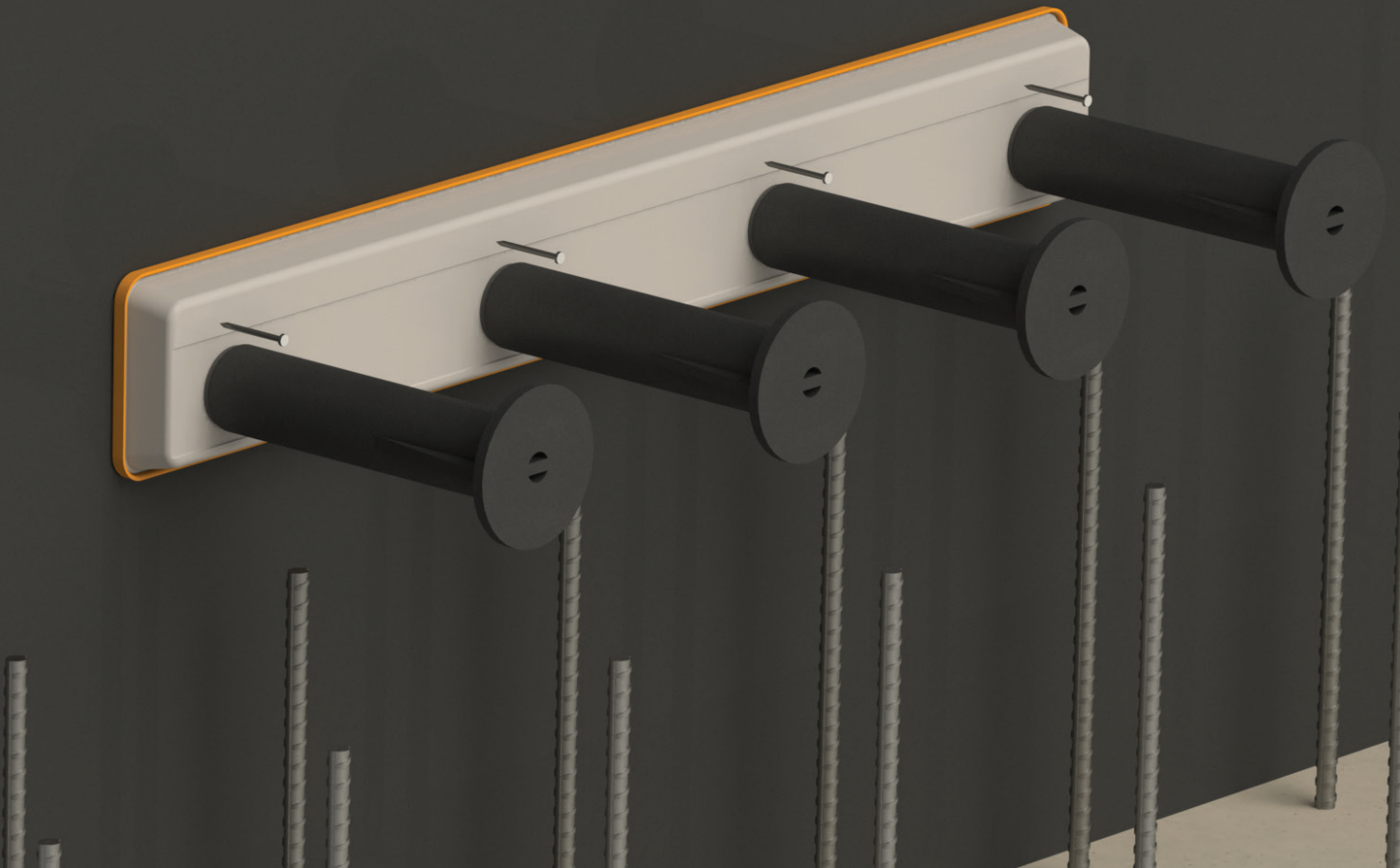

Genuine ReidBar™

Floor to Wall Connection Systems

Designed to efficiently and safely place
ReidBar™ reinforcing connections at the
Floor to wall intersection in Insitu and
Precast construction applications.



ReidBar™

Floor to Wall Connection Systems

A range of rebated carrier systems for commercial building applications designed to efficiently and safely place ReidBar™ reinforcing connections at the Floor to Wall intersection in Insitu and Precast construction applications.

All ReidBar™ systems and design details are value engineered to optimize performance and constructibility while delivering low cost in place.

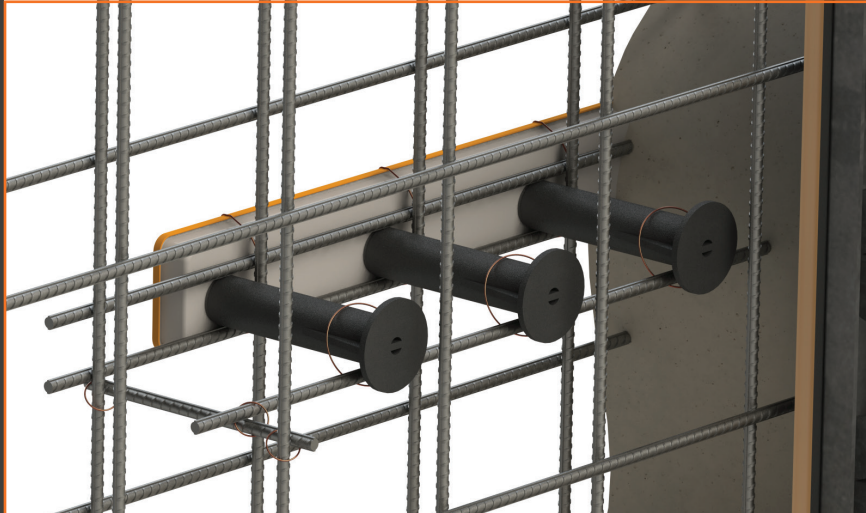

ReidBox™ Connection System

ReidBox™ Connection Systems are value engineered to utilize the ductile properties of the ReidBar™ Reinforcing Bar. Our optimized design and detailing develops a full strength reinforcing connection of concrete framing elements, ensuring the integrity of the building's structural system whilst reducing labor and cost in place.

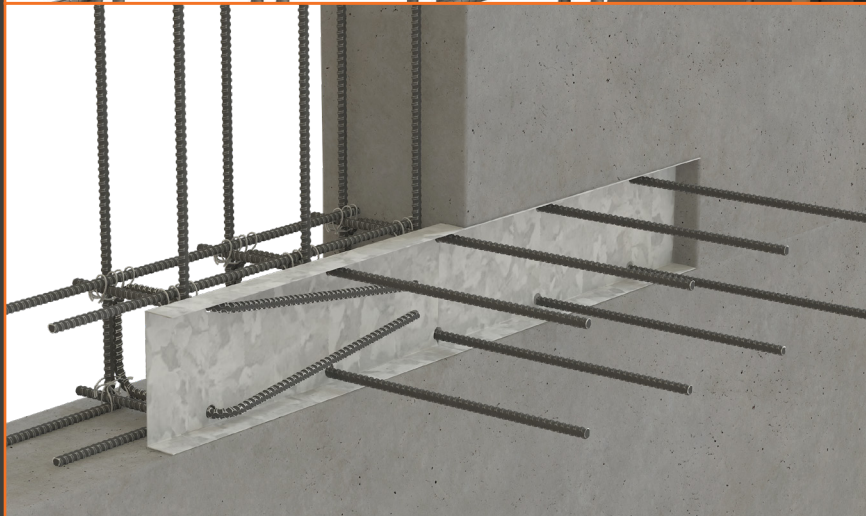

ReBox™ Pull Out Box Connection System

Reid™ ReBox™ is our traditional Pullout Box system manufactured with bars pre-bent from 500N Grade ReidBar™ inside a galvanized box and lid. Attached to either the formwork or the reinforcing cage the Rebox™ system provides the ability to connect by bending the bars out of the box once the concrete has been poured and the formwork is stripped.

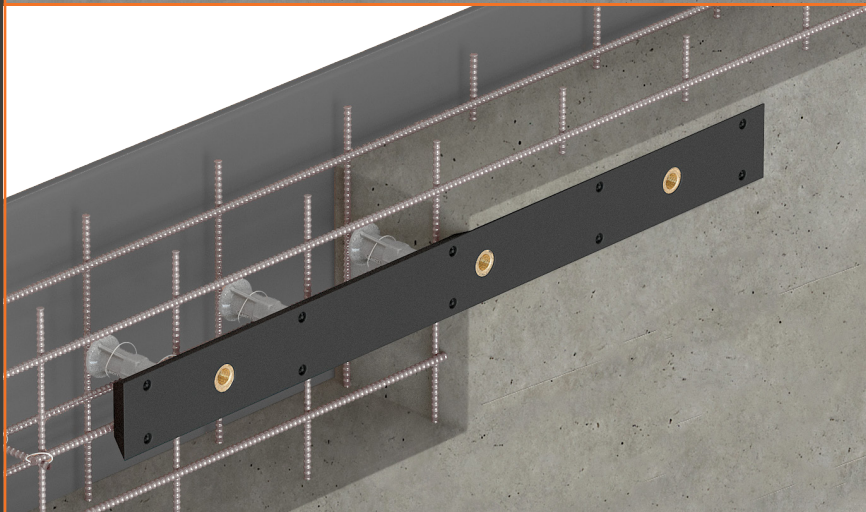

ReidBar™ Poly Board Connection System

ReidBar™ Poly Boards are a reusable carrier system designed to place ReidBar™ Connections quickly and accurately reducing labor and cost in place.

Systems Overview

A range of rebated carrier systems for commercial building applications designed to efficiently and safely place ReidBar™ reinforcing connections at the Floor to Wall intersection in Insitu and Precast construction applications.

ReidBox™ Connection System



ReBox™ Pull Out Box Connection System

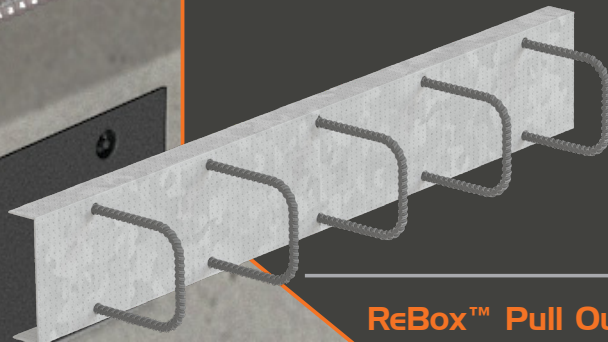

ReidBar™ Poly Board Connection System

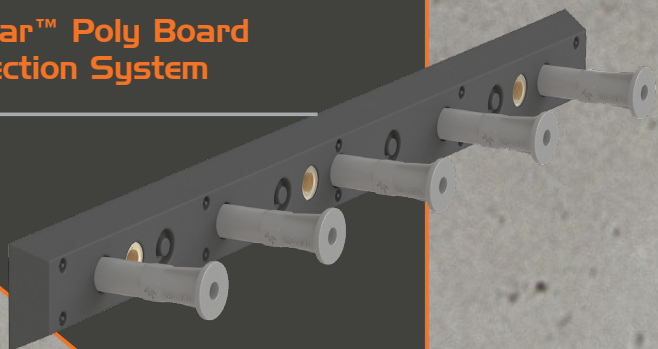

Compliance & Certification



Genuine ReidBar™ Connection System

ReidBar™ Connection Systems comply to the relevant standards and codes with certification and traceability in place from raw material to finished product stage.

Table 1: Compliance









Standard / Code	Compliant
AS/NZ4671:2001	
AS3600:2018	
NZS3101:2006 A3	

Table 2: Certification

Certification	Complete
ACRS Certified Systems (Reidbar™ Systems)	
ISO Certification System and Testing	
Supplier Certification ISO9001:2000	
Batch Traceability of Raw Material	
Third Party Testing Verification	

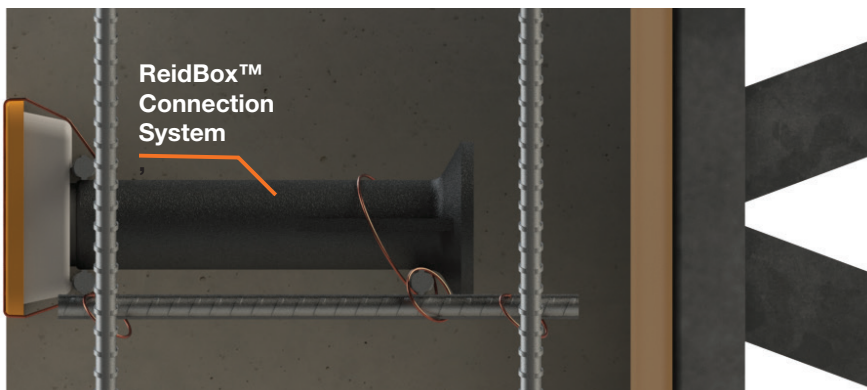

Quality
ISO 9001
SAI GLOBAL

Project Delivery



The ramsetreid™ team provide project support at every stage of the Design, Specification, Procurement and Construction Process.

Our team will work with the project stakeholders on specification requirements to provide solutions that optimize performance and cost in place efficiencies.

Project Phases

1



Design

Value Engineering

- Specification support
- Compliance
- Risk Mitigation (Design)
- Optimise Cost in Place
- Safety

2



Procurement

Admin Support

- Shop Drawing
- Scheduling
- Cost Control
- Traceability

3

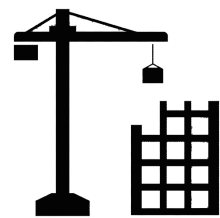

Construction

Delivery

- Pre Manufacture
- Scheduled Delivery
- Site Support

ReidBar™
Poly Board
Connection
System



Reid customer service

Reid™ Australia

Customer Service Centre

Tel: 1300 780 250

Email: sales@reid.com.au

Web: reid.com.au

Reid™ New Zealand

Customer Service Centre

Tel: 0800 88 22 12

Email: sales@ramsetreid.co.nz

Web: www.reids.co.nz



ramsetreid™ 1 Ramset Drive, Chirnside Park 3116

Information in this document is correct at the time of printing. Readers should contact ramsetreid™ or consult ramsetreid™ detailed technical information to ensure product is suitable for intended use prior to purchase. ITW Australia Pty Ltd ABN 63 004 235 063 trading as ramsetreid™

© copyright 2020.™ Trademarks of Cetram Pty. Ltd. Used under license by ramsetreid™
Imagery showing graphic concrete is used with permission of Graphic Concrete Ltd.

June | 2020

AUS & NZ