

2019

australia edition

tilt-up solutions

product guide

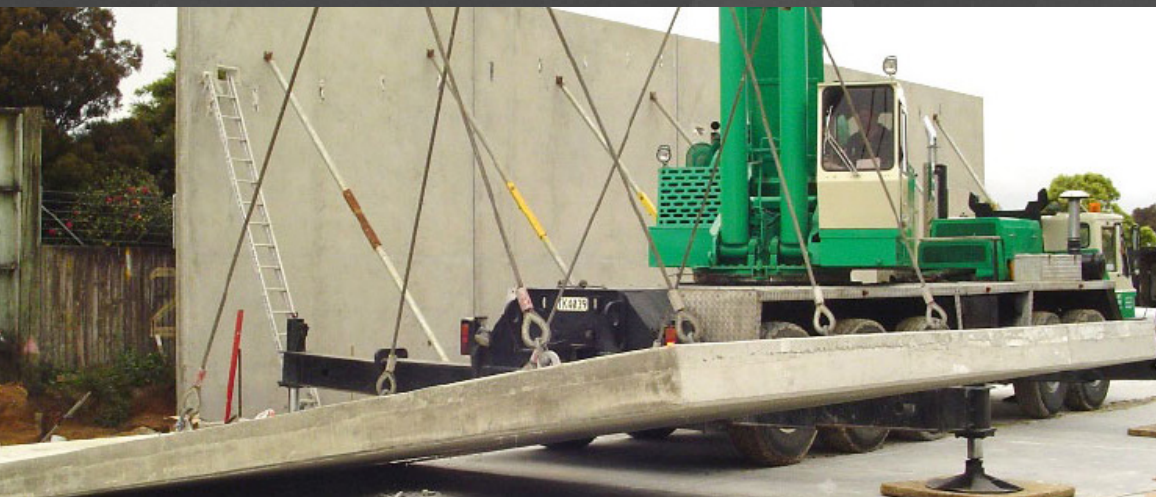

RR
ramsetreid

product guide | 2019

**tilt-up
solutions**



CONTENTS

Lifting	4
Ramset™ FaceLifters	
Reid™ Swiftlift™ FaceLifters	
Reinforcing	6
ReidBar™	
Chairing	8
Reinforcing Support Chairs	
Connections	9
Reid™ Elephant Foot™ Ferrules	
Chemicals	11
Nox-Crete Silcoseal Select	
Nox-Crete Silcoseal Classic	
Nox-Crete Blast-Off	
Nox-Crete Sprayer Systems	
Erection & Installation	16
OrbiPlate™	
Reid™ Ferrule & Coil Bolt	
Reid™ BraceSet™	
Reid™ Shims	

Ramset™ FaceLifters

Consistent with the Reid™ commitment to local testing, Ramset FaceLift Anchors have been extensively tested in Australian concrete. Analysis of the subsequent test data in accordance with AS3850.1:2015 Appendix A results in Ramset FaceLift Anchors having Working Load Limit capacities that are far higher and more accurate than those simply calculated using the CCD method applicable for footed anchors.

A fully featured FaceLift system with the security of additional reinforcing which provides durability and maximises safety.

- Solid fixing into reo/mesh via integral bar clip.
- Floating bar clip floats with mesh to prevent anchor movement when trafficked.
- Complies with AS3600-2001 for concrete cover.
- Full plastic underside protection to maximise concrete cover and withstand collisions.
- Easy and fast void removal.
- Increased safety with bolt in redundancy and guaranteed ductile failure mode in case of concrete failure or overloading.



AS 3850
Compliant



Load Group	To Suit Panel Thickness (mm)	Head Identification	Pack Quantity	Part No.
5 tonne	150	5TR132	16	FL050150B
5 tonne	175	5TR157	16	FL050175B
5 tonne	200	5TR157	16	FL050200B

Note: Ramset FaceLifters require either Reid SwiftLift 3DX85LC.

Compatible Clutch for Ramset FaceLifters

Clutch	Clutch Part No.	Working Load Limit	Colour	Image
Reid SwiftLift™ 3Dx™	3DX85LC	8.5t	Yellow	

NOTES:

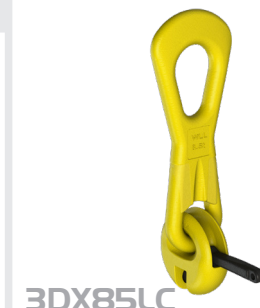

ReidTM SwiftLiftTM FaceLifters

The Reid SwiftLift FaceLifter features a unique robust wire chair to ensure performance under the harshest conditions.

- High strength wire chair.
- Plastic coated feet.
- Close reinforcement placements.
- Solid fixing into reo/mesh via integral bar clip.
- **Floating bar clip floats with mesh to prevent anchor movement when trafficked.**
- Easy and fast void removal.



AS 3850
Compliant



Load Group	To Suit Panel Thickness (mm)	Head Identification	Pack Qty	Part No.
5 tonne	125	5 x 95	16	RFL125
5 tonne	150	5 x 120	16	RFL150
5 tonne	175	5 x 120	12	RFL175
6 tonne	200	5 x 170	12	RFL200

Note: The SwiftLift Face Lifter uses a AS3850.1:2015 compliant foot anchor. It requires a Reid SwiftLift 5LE clutch.

Compatible Clutch for Reid SwiftLift FaceLifters

Clutch	Clutch Part No.	Working Load Limit	Colour	Image (below)
Reid SwiftLift	5LE	5t	Silver	1

NOTES:



ReidBar™ System And Components

ReidBar is a reinforcing bar that can be cut at any point along its length and screwed into the range of ReidBar threaded components.

This unique feature enables an entirely new approach to reinforcement placing and fixing. ReidBar threaded reinforcing provides simple solutions for construction problems, reducing both labour and material costs.

ReidBar Starters

ReidBar starter bar systems have been developed to provide full strength and positive connections between precast concrete panels, floor slabs and insitu suspended floors.

Part No.	Description	Length (mm)	Pack Quantity
RB12SB	Starter bar for RB12 fittings	540	50
RBA16SB	Starter bar for RBA16 fittings	660	50

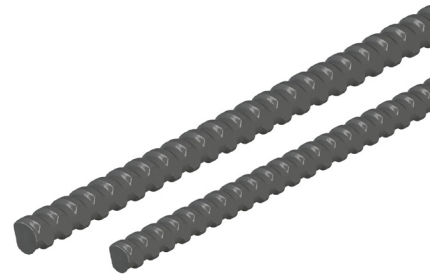

ReidBar Inserts

System to anchor ReidBar. Commonly utilised for floor to wall or floor to panel connections.

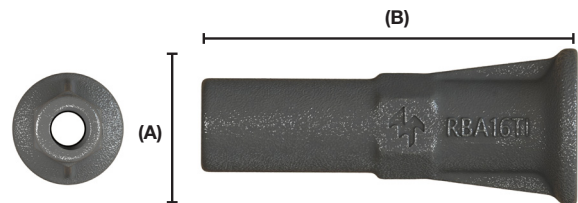

Part No.	Description	Foot Diameter (A) (mm)	Length (B) (mm)	Pack Quantity
RB12TI	ReidBar Insert for RB12	38	100	60
RBA16TI	ReidBar Insert for RBA16	50	118	30

* Galvanised Inserts available lead time applies.

ReidBar Wing Nut

System to fix and/or tighten ReidBar.
Commonly utilised for formwork systems.



Part No.	Description	Hex A/F	Height (mm)	Overall Diameter (mm)	Pack Quantity
RB12WN	ReidBar Wing Nut for RB12	22	40	58	100
RBA16WN	ReidBar Wing Nut for RBA16	30	51	98	30

ReidBar fittings are accompanied by various accessories that made their installation easier.

Mainly for attaching ReidBar Inserts to timber formwork



Prevents concrete slurry entering and fouling ReidBar Insert threads.

[illegible]

Reinforcing Support Chairs

Mesh Chair

The mesh chair is designed to clip easily to the intersection of the mesh, providing greater strength and stability. Mesh chairs can be used with extensions for added height if required.

Cover (mm)	Pack Quantity	Part No.
20	100	MESH20
25	100	MESH25
30	100	MESH30
35	100	MESH35
40	100	MESH40
50	100	MESH50
60	100	MESH60
65	100	MESH65
75	100	MESH75



Panel Chair

Designed to support single layered mesh in tilt-up panels. The easy push on clip mechanism allows the chair to swing into a vertical position when lowering the mesh into the form and suits all mesh sizes including N12 bars. Dimples located at the base of the legs ensures minimum exposure.

Cover (mm)	Pack Qty	Pallet Quantity	Part No.
30/40	100	5000	BCPANEL3040
50/60	100	5000	BCPANEL5060
65/75	100	5000	BCPANEL6575
90/100	100	5000	BCPANEL90100



Top Deck Chair

The dual height top deck chair has been designed to support both top mesh and top reinforcing bars in sus decks, thick tilt-up panels and any tall spacer applications, where strength and stability is critical.

a (Height)	b (Height)	Pack Quantity	Part No.
90	100	50	BPDST090100
110	120	50	BPDST110120
130	140	50	BPDST130140
150	160	50	BPDST150160
170	180	50	BPDST170180
190	200	50	BPDST190200

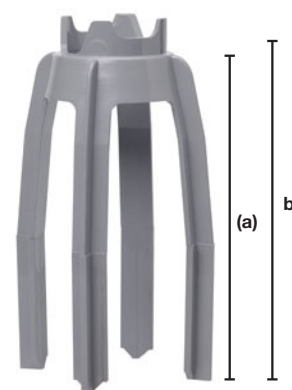

Reid™ Elephant Foot™ Ferrules

The Reid Elephant Foot Ferrule is a premium grade, medium to heavy duty, cast-in ferrule, and compliant to AS3850.1:2015.

Elephant Foot™ Metric Ferrule Key Features:

- 5.8 grade steel or 316 grade Stainless Steel.
- Use in near or far face applications with our range of accessories.

Designed to produce a ductile connection when used in conjunction with grade 4.6 bolts.

- Waisted design ensures capacity is not limited by the steel strength at the cross hole.
- Cross hole to suit N12 on larger sizes.
- Footed design ensures maximum concrete capacity without the need for a cross bar.
- May be used with rebar for fixing to mesh.

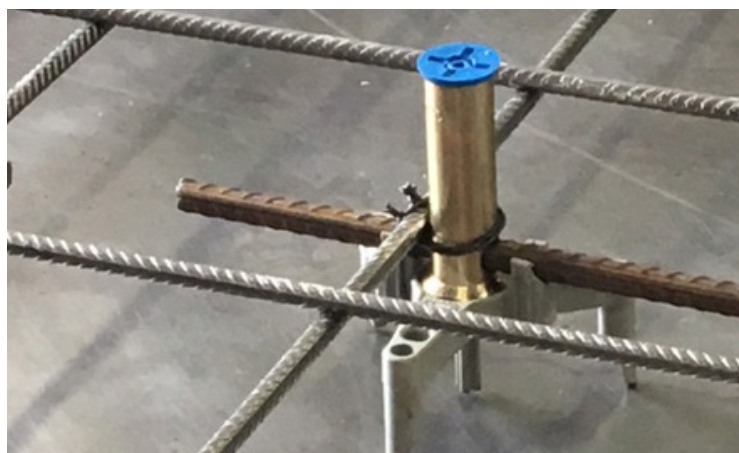
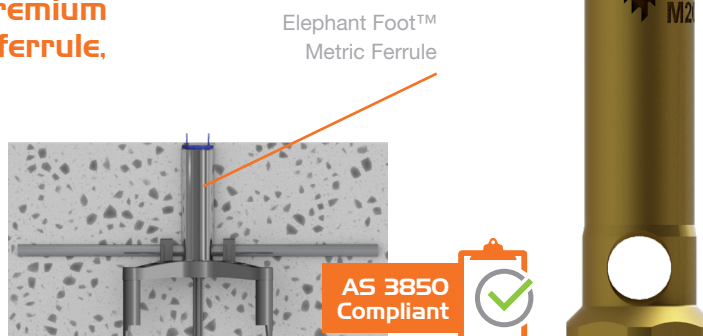

Typical near face application displayed above including accessories: ferrule chair and locator cap.

Ferrule size, db	Ferrule length, L (mm)	Cross hole to suit	Pack Quantity	Part No.		
				Zn	Gal	316SS
M10	45	R8	220	FE10045	-	FE10045SS
M12	55	R8	170	FE12055	FE12055GH	FE12055SS
	95	N12	100	FE12095	FE12095GH	-
M16	70	N12	80	FE16070	FE16070GH	FE16070SS
	95		65	FE16095	FE16095GH	-
M20	70	N12	75	FE20070	FE20070GH	-
	95		50	FE20095	FE20095GH	FE20095SS
M24	95	N12	35	FE24095	FE24095GH	-

Reid™ Stiletto™ Ferrule Chair

The Reid Stiletto ferrule chair is the most stable and secure chairing solution for a wide range of Reid ferrules. Designed with 3 legs, to take up variations in the bed, as well as a central support that provides additional strength when required.

- Can be positioned within 40mm of panel edge – much closer than other chairs on the market.
- Minimum voids due to small foot print and shape of the legs.
- Dimple in the centre of the chair for central location of the ferrule.

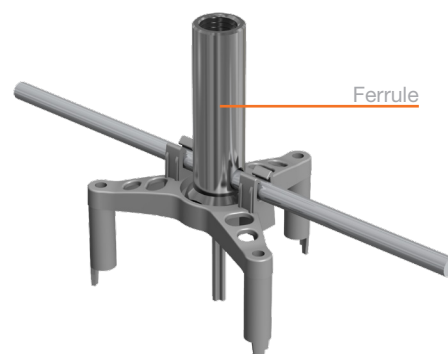

Note: Ferrule Length Required to suit panel thickness - All measurements (mm)

Stand Height	Panel Thickness					Pack Quantity	Part No.
	100	125	150	175	200		
25	70	95				50	FSC25
50		70	95			50	FSC50
75			70	95		50	FSC75
100				70	95	50	FSC100

Reid SwiftCap™

Designed with specially tapered sides that induce a crack line at the concrete surface when removing, allowing easier, cleaner removal. Can also be fastened to formwork and used as an economical quick fit locator.

Accessories

To Suit	Pack Qty	Colour	Part No.
M16	100	Green	SCM16
M20	100	Blue	SCM20

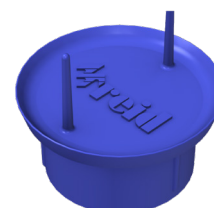

Ferrule Nailing Plate

Reusable locator for ferrules on timber form.

To Suit	Pack Quantity	Colour	Part No.
M12	100	Red	FM12N
M16	100	Green	FM16N
M20	100	Blue	FM20N
M24	100	Yellow	FM24N



Ferrule Quick Fit Locator

Pushes into the ferrule and releases when the panel is lifted. A special built-in seal prevents slurry leakage into the ferrule. The 45mm square base can be nailed, or will accommodate double sided tape, which can be cut from standard strips.

To Suit	Pack Quantity	Colour	Part No.
M12	100	Red	FWQF12
M16	100	Green	FWQF16
M20	100	Blue	FWQF20





Nox-Crete Silcoseal Select

The premium bond breaker on the Australian market today, providing unsurpassed performance in a water-based formulation. Silcoseal Select Cure and Bondbreaker is suitable for most applications and produces superior concrete finishes with less lifting suction when compared to solvent based alternatives. Silcoseal Select is a chemically reactive bond breaker which reacts with concrete to achieve a clean and crisp release. Panels produced with Silcoseal Select require minimal surface preparation prior to painting.

A superior water based emulsion, Silcoseal Select produces a high performance result, while reducing environmental impact during use.

The finished panel is free of waxy residues which makes it ideal for the application of water based coatings such as acrylic paints.



-  **Non toxic**
-  **No petroleum**
-  **No clean up**

Uses

- Achieves exceptional wall panel surface appearance. A crisp, positive release that minimises panel surface defects and reduces panel resurfacing/patching costs.
- Improved resistance to the “osmotic effect” by restricting the natural tendency for water to migrate from freshly placed panel concrete through the bondbreaker film and into the less moist casting slab.
- Leaves no residue or resulting staining on wall panel or casting slab floor surfaces when properly applied.

Product Information

Silcoseal Select consists of a special formulation of chemically reactive organic compounds in a predominately water based solvent system which chemically react with calcium hydroxide, a byproduct of the cement hydration reaction.

Improved formulation eliminates the need for a Hazardous Material label, reducing delivery costs and increasing job site safety. It is recommended to blend and shake the product before use to enable an evenly dispersed emulsion for superior results.

Improved emulsion technology allows excellent usage rates, allowing less product to be used as compared to heavy solvent based, waxy, barrier type bondbreakers.

Application Guidelines

Improved formulation eliminates the need for a Hazardous Material label, reducing delivery costs and increasing job site safety. Use the Nox-Crete Drum Agitator or other suitable mechanical agitator to adequately mix product before withdrawing from container and before each use. Typical drying time is 30 minutes to 3 hours, but varies with the presence or absence of a moisture barrier beneath the casting slab, climatic conditions and application rate. Reducing the application rate and applying in multiple thin coats in lieu of one heavy coat will greatly reduce drying time.

For further information refer to the **Product Technical Data sheet**

Product	Size	Part No.
Silcoseal Select	200 litre	NOXSILCOSEL200
Silcoseal Select	20 litre	NOXSILCOSEL20

Related Products

Part No.	Desc	Pack
NOXPERFECT	Nox-Crete Concrete and Form Sprayer	10L
NOXCFVALVE40	Nox-Crete CF Valve 40psi	ea
NOXTIP8004	Nox-Crete Tee-jay spray tip 8004	ea

Nox-Crete Silcoseal Classic

Silcoseal Classic's traditional, solvent-based formulation allows tilt-up panels to separate easily and completely without the use of pry bars or wedges commonly used with membrane-forming bondbreakers. The solvent-based formula also dries faster than water-based formulations and isn't affected by high humidity.

Instead of containing wax or hydrocarbon resins like other membrane forming bondbreakers, Silcoseal Classic is formulated with organic compounds which are chemically reactive.

Uses

- Use as a cure and bondbreaker in tilt-up, lift slab and precast concrete construction when weather conditions do not allow for the use of water-based products.
- Use to cure the top side of tilt wall panels to prevent the formation of shrinkage cracks.

Use as a cure only on all types of interior, smooth trowelled concrete flatwork where the use of conventional resin-based curing compounds is impractical.

Product Information

Silcoseal Classic contains organic compounds that react chemically with excess limes present in the concrete surface and when properly applied, eliminate wall panel sticking. The absence of wax or hydrocarbon resins means less Silcoseal Classic needs to

be used per project, reducing application time and cost while ensuring exceptional results. Site cast wall panels separate easily and completely without the need for pry bars or wedges commonly used with membrane-forming bondbreakers.

Application Guidelines

Silcoseal Classic is commonly applied first as a cure coat to freshly placed concrete. Cure coats can be applied at a rate of 5-10 m² per litre of product. After cure, two coats of Silcoseal Classic can be applied at right angles to each other to ensure uniform coverage. Typical coverage rates per coat of Silcoseal Classic are 5-10 m² per litre of product. Application rates can vary widely due to specific conditions. Take care not to under or over apply. A NOXPERFECT sprayer, with the prescribed control flow valve and spray tip, provides excellent application results.

For detailed instructions on application, please refer to the Technical Data Sheet.

Product	Size	Part No.
Silcoseal Classic	200 litre	NOXSILCOCLASS200
Silcoseal Classic	20 litre	NOXSILCOCLASS20



- ✓ **Forgiving**
- ✓ **High coverage**
- ✓ **Reduce your costs**

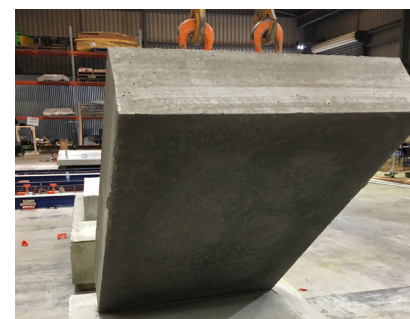

After application

Related Products

Part No.	Desc	Pack
NOXPERFECT	Nox-Crete Concrete and Form Sprayer	15L
NOXCFVALVE40	Nox-Crete CF Valve 40psi	ea
NOXTIP8004	Nox-Crete Tee-jay spray tip 8004	ea

Nox-Crete Blast-Off

A powerful water based cleaning agent formulated to dissolve concrete build-up on heavy industrial equipment.

Features & Benefits

- Contains a concentrated organic acid derived from sugar cane and sugar beets
- Extremely fast-acting formula quickly dissolves concrete splatter and hardened build-up
- Small molecular size allows deep penetration into the heaviest build-up
- Water based and readily biodegradable (90% in 7 days)
- Contains no mineral acid and is odour free
- Produces a thick, rich foam that clings to vertical and overhead surfaces for increased effectiveness
- Will not corrode steel, aluminium, magnesium, copper or damage plastic, fiberglass or rubber surfaces
- Requires use of a Nox-Crete Pump Foamer
- Vivid pH-sensitive purple dye indicates product is still working

Uses

- Use on aluminium, steel, plastic, fiberglass, glass, rubber or painted metal surfaces
- Removes build-up and splatter on drum mixers, forms, paving machines, concrete pumps, screeds and more
- Can also be used to remove mortar splatter, efflorescence and other calcium based salt deposits from concrete masonry surfaces
- Excellent for small hand tools as well as heavy industrial concrete equipment

Product Information

Nox-Crete BLAST-OFF contains powerful naturally derived molecules which are extremely effective at dissolving concrete build-up and splatter without damaging or corroding exposed steel, chrome, aluminium or electrical components.

Eliminates costly damage resulting from the use of sandblasters or chipping hammers, increasing the life of expensive capital equipment. It is water based and readily biodegradable allowing it to be used and disposed of safely on several work sites.

Application Guidelines

Ready to use formulation. Best results are achieved by using a pump foamers such as Nox-Crete Pump Foamer. This will produce a thick, rich foam that will cling to the steel surface allowing the product to work effectively. The pH sensitive dye indicates that BLAST-OFF is actively dissolving hardened concrete build-up, turning white when finished, allowing the user to see when the reaction is neutralized and can be easily rinsed off.

Remove softened concrete with a garden type spray nozzle of a pressure washer for removal of heavier build-up. Occasionally re-application or longer soaking times may be required for particularly heavy build-up.



Before application



After application

Packaging & Product Codes

Part No.	Size	Pack
NOXBLAST20	20L	Pail

Related Products

Part No.	Desc	Pack
NOXFOAMPUMP	Nox-Crete Pump Foamer	ea

Nox-Crete Sprayer Systems

High quality, robust sprayers to maximise chemical delivery and performance.

Sprayer System Selection Guide

	Sprayer System	Product	Spray Tip	Environment	Application
Tilt-up & In-Situ	NOXPERFECT	Silcoseal SELECT, Silcoseal CLASSIC	8001 8004	Exposed/Outdoor Windy Conditions	Tilt-up construction Semi-absorbent formwork
Maintenance	NOXFOAMPUMP	BLAST-OFF	N/A	Indoor/Outdoor	Formwork and concrete equipment

Nox-Crete Perfect Concrete & Form Sprayer

Product Information

The Nox-Crete PERFECT Concrete and Form sprayer is a heavy duty stainless steel sprayer for Precast, tilt-up and concrete construction sites. It can be hand pumped or air-charged to 6.2 bar (90 psi), making it a versatile and robust sprayer on large construction sites and tilt up yards for the delivery of form release agents and chemical bond-breakers.



Features & Benefits

- Gun-style handle and trigger
- 2.8 bar (40 psi) control flow (CF) valves maintain constant pressure for consistent spray flow
- Heavy-duty, 15L stainless steel tank
- 1.5 m (5 ft.) chemical-resistant hose with swivel

Uses

- Application of Nox-Crete formrelease agents and bond-breakers
- Recommended for Precast and tilt upyards, as well as construction sites

Can be hand pumped or air charged

Part No.	Desc	Pack
NOXPERFECT	Nox-Crete Concrete and Form Sprayer	15L

NOTES:

Product Information

Features & Benefits

-

Part No.	Description	Pack
NOXCFVALVE40	Nox-Crete CF Valve 40 psi	each
NOXTIP8004	Nox-Crete Teejet spray tip 8004	each
NOXTIP8001	Nox-Crete Teejet spray tip 8001	each
NOXSERVICE-PF	NOXPERFECT Spare part kit	each

Part No.	Size	Pack
NOXPERFECT	15L	ea
NOXFOAMPUMP	7.5L	ea

Using the complete Nox-Crete sprayer system is highly recommended to achieve the full potential of Nox-Crete form release agents and maintenance chemicals. The sprayer recommendations have been derived specifically based on the product material properties to ensure an exceptional and economical result.

NOTES:

[illegible]

Reid™ Footed Bracing Ferrule & Coil Bolt

Reid Footed Bracing Ferrule is specifically designed for use with the Reid Coil Bolt for bracing applications. Manufactured from Class 5.8 steel, the footed bracing ferrule is suitable for use in near or far face applications with the Reid range of accessories. The footed design ensures maximum concrete capacity without the need for a cross bar.

The Coil Bolt is designed with a coil thread to provide maximum tolerance to concrete slurry and to enable fast secure installation. The flanged head coil bolt has a 38mm serrated washer face that suits slotted plates.

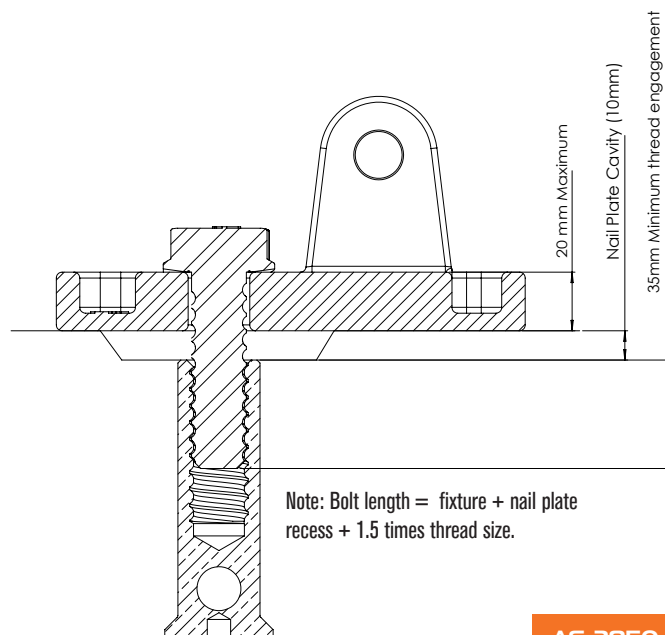

Footed Bracing Ferrule Key Features:

- Class 5.8 steel.
- Use in near or far face applications with the Reid range of accessories.
- Footed design ensures maximum concrete capacity without the need for a cross bar.
- May be used with rebar for fixing to mesh.
- Reid™ logo and material grade stamped on ferrules.

AS 3850
Compliant



Description	Ferrule OD (mm)	Ferrule length, L (mm)	Thread length, Lt (mm)	Cross hole to suit	Part No.
Reid Footed Bracing Ferrule	28	95	38	N12	CBF2095

Description	Thread Length	Pack Quantity	Part No.
Reid Coil Bolt	62	50	CBW2065

Accessories:

Bracing Ferrule Nailing Plate

To Suit	Pack Quantity	Part No.
Reid Footed Bracing Ferrule	100	NPCBI

NOTES:

Reid™ BraceSet™ Bracing Anchor

Reid BraceSet Bracing Anchor is the ideal solution for anchoring the slotted feet of concrete wall panel braces, at either end of the brace.

BraceSet is a Heavy Duty load controlled torque setting expansion anchor, using a common 30mm AF hex head socket. Compliant to AS3850.1:2015, BraceSet provides high tensile and shear capacities (Tensile capacity (kN) of 16.2). Ideal for use at either end of the precast panel brace, it is simple to remove leaving no messy protrusions.



AS 3850
Compliant



Large 30mm AF head and 38mm washer.

Bolt head spans the brace foot slot structurally, does not rely on the fitting of a separate washer.

High shear capacity for a 20mm diameter anchor.

16mm diameter shear zone gives upto 5% higher shear capacity than M12 based bolts.

Pull down sleeve ensures fixture clamping.

If required, the pull down sleeve reduces in height, drawing the fixture down tight against the substrate.

Locking cone nut engages the concrete.

Reliable clamp load creation means consistently higher capacity.

BraceSet Bracing Anchor Key Features:

- Heavy Duty load controlled torque setting expansion anchor.
- High tensile and shear capacities.
- Uses a common 30mm AF hex head socket.
- 20mm diameter drilled hole.
- Ideal for use at either end of the precast panel brace.
- Simple removal leaving no messy protrusions.

Installation details

Part No.	Concrete drilled hole diameter	Maximum fixture thickness	To suit bracefoot slot width	Tightening torque	Minimum dimensions		
	(mm)	(mm)	(mm)	(Nm)	Anchor edge distance e_c (mm)	Anchor spacing a_c (mm)	Substrate thickness (mm)
BA20115	20	25	21 - 26	150	300	500	150^

Description	Anchor Size (mm)	Drilled Hole Diameter (mm)	Tightening Torque (Nm)	Pack Quantity	Part No.
Reid BraceSet Bracing Anchor	M14	20	150	40	BA20115

Reid™ Shims

Reid Shims have been independently tested and rated with a 20t Working Load Limit determined in accordance with AS 3850.1:2015.

Key Features:

- Reid Shims are permanently marked with 20t WLL and the Reid logo for identification.
- Designed for temporary levelling support for panels.
- Colour coded by thickness for ease of selection, Reid Shims are manufactured from quality plastic and tested with compressive tests up to 20 tonnes.

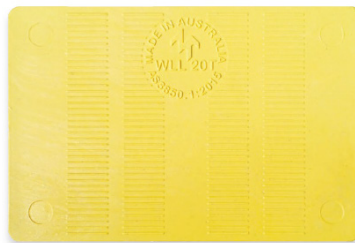

AS 3850
Compliant



Product Codes

Shim Thickness (mm)	Colour	Pack Quantity	Part No.
1	Brown	100	SHIM01
2	Blue	200	SHIM02
3	Green	100	SHIM03
5	Yellow	100	SHIM05
10	Black	40	SHIM10
15	Grey	40	SHIM15
20	White	30	SHIM20

NOTES:

OrbiPlate™

OrbiPlate™ overcomes the major headache that comes with bolted connections, getting the holes to line up! The methods traditionally used to overcome this were time consuming, costly and often structurally inadequate.

The patented OrbiPlate system is used when connecting steel to steel or steel to concrete elements and delivers connection tolerances of up to 20mm around the centre of the connection. It also provides the ability to achieve fine locational accuracy when positioning each steel member.

OrbiPlate is quick and easy to install. The steel member is supplied to site with a pre-formed hole (70mm), which can be punched or cut at the centre of the connection location. The main washer is then placed over the hole, rotated to locate the slot over the ferrule, then secured using the class 8.8 bolt through the small washer. The bolt can be positioned anywhere along the elongated slot, providing up to 20mm tolerance in all directions.

Features & Benefits

- Utilises readily available Reid™ Elephant Foot™ ferrules for steel to concrete connections.
- OrbiPlate is made from high tensile steel.
- Hot Dip Galvanised finishes.
- It is comprising of two washers (one large and one small) and is supplied with a M20 class 8.8 bolt.
- Capacity is limited to either the ferrule cast into the concrete or the class 8.8 bolt*.

Advantages

- No lost time.
- No hot work, either blowing out holes or welding.
- No call outs when connections don't line up.
- OrbiPlate locks in place.
- Fine positional adjustment allows accurate positioning of each steel member.
- OrbiPlate provides a high capacity structural connection*.



Provides ± 20mm positional tolerance. No rework or call outs when connections don't line up.

***Refer to the OrbiPlate Engineer's Design Guide for design capacities for both steel to concrete & steel to steel applications.**

Product Codes

OrbiPlate fits into a pre-formed hole in steel component (diameter 70mm ± 1mm)

Size	Part No.	Finish	Matching Ferrule	Fixture Thickness
M16	ORB2016BGH	HDG	FE16095GH	6 - 12mm
M20	ORB2020BGH	HDG	FE20095GH	6 - 16mm

customer service

Reid™ Australia

Customer Service Centre

Tel: 1300 780 250

Email: sales@reid.com.au

Web: reid.com.au

ramsetreid™ 1 Ramset Drive, Chirnside Park 3116

Information in this document is correct at the time of printing. Readers should contact ramsetreid™ or consult ramsetreid™ detailed technical information to ensure product is suitable for intended use prior to purchase. ITW Australia Pty Ltd ABN 63 004 235 063 trading as ramsetreid™

© copyright 2017. ™ Trademarks of Cetram Pty. Ltd. Used under license by ramsetreid™

